

(1)	(2)	(3)	(4)	(5)	(6)	(7)	(8)	(9)	(10)	(11)	(12)	(13)	(14)
SMR	Federal	DESCRIPTION	Unit	meas	in	Unit	per	alw	maint	per	alw	(a)	(b)
Code	Stock	Number					100	per	100	Figure	Item		
							cnt-	equip	No.		No.		
Reference Number & Mfr. Code	Usable On Code		(a)	(b)	(c)	(a)	(b)	(c)					
2001-HOIST, WINCH, CRANE ASSEMBLY-CONTINUED													
P-O	4730-050-42	FITTING,LUBRICATION:SHORT ROLLER SHAFT MS15003-1 (96906)	HA,FJ,JA	EA	2	*	*	*	*	*	*	8	10 221 9
P-F	2520-740-99	SHAFT:REAR WINCH SIDE ROLLER 7409947 (19207)	HA,FJ,JA	EA	1	*	*	*	*	*	*	4	8 221 10
P-F	2590-400-70	PLATE:ROLLER SHAFT M305852 (24076)	HA,FJ,JA	EA	1	*	*	*	*	*	*	3	5 221 11
P-F	5310-637-95	WASHER,LOCK:ROLLER SHAFT PLATE MS35338-46 (96906)	HA,FJ,JA	EA	3	*	*	*	*	*	*	6	10 221 12
P-F	5305-269-28	SCREW,CAP,HEXAGON HEAD: ROLLER SHAFT PLATE MS90726-58 (96906)	HA,FJ,JA	EA	4	*	*	*	*	*	*	6	10 221 13
P-F	5305-226-77	SCREW,CAP,HEXAGON HEAD: SPROCKET, DRIVE WHEEL MS90726-109 (96906)	HA,FJ,JA	EA	1	*	*	*	*	*	*	6	10 222 1
P-F	5310-584-52	WASHER,LOCK:SPROCKET DRIVE WHEEL (1) WINCH HOUSING (4) MS35338-48 (96906)	HA,FJ,JA	EA	5	*	*	*	*	*	*	6	10 222 2
P-F	5310-595-58	WASHER,FLAT:SPROCKET DRIVE WHEEL 8330414 (19207)	HA,FJ,JA	EA	1	*	*	*	*	*	*	6	10 222 3
P-F	2520-287-86	SPROCKET:DRIVE (USED WITH CHAIN, FSN 2520-741-7085 AND SPROCKET, FSN 2590-287-8679), (USED ON VEHICLES THROUGH SERIAL NO. 2427) 5Y789 (24076)	HA,FJ,JA	EA	1	*	*	*	*	*	*	6	10 222 4
P-F	2520-288-08	SPROCKET:DRIVE (USED WITH CHAIN, FSN 2520-692-6165 AND SPROCKET, FSN 2590-569-892), (USED ON VEHICLES AFTER SERIAL NO. 2427 (HA) 12665R1 (310070)	FJ,HA,JA	EA	1	*	*	*	*	*	*	6	10 222 4
P-F	3120-740-99	HOUSING:WINCH DRIVE SHAFT, WITH BEARINGS 7409904 (19207)	HA,FJ,JA	EA	1	*	*	*	*	*	*	3	5 222 5
P-F	2520-350-74	SPACER:WINCH DRIVE SPROCKET 6Y2057 (24076)	HA,FJ,JA	EA	2	*	*	*	*	*	*	4	8 222 6
X1		CAP:HOUSING WINCH DRIVE 8210708 (19207)	HA,FJ,JA		2								222 7
P-F	2520-350-52	GASKET:WINCH DRIVE SPROCKET PILLOW BLOCK 7Y2033 (24076)	HA,FJ,JA	EA	2	*	*	*	*	*	*	15	40 222 8
P-F	5330-286-81	SEAL,PLAIN ENCASED:WINCH DRIVE SPROCKET PILLOW BLOCK 500097 (21450)	HA,FJ,JA	EA	2	*	*	*	*	*	*	10	100 222 9

(1) (2)  
SMR Federal  
Code Stock  
Number

(3)  
DESCRIPTION

TM9-2320-211-34P

(4) (5) (6)  
of inc. allowance  
meas in  
Unit

(7)  
allowance  
allowance

(8) (9) (10)  
alw maint  
per alw  
100 per (a) (b)  
equip100 Figure Item

Reference Number & Mfr. Code

Usable On Code

(a) (b) (c) (a) (b) (c)  
1-20 21-5(51-10(1-20 21-5(51-10)gcy

2001-HOIST, WINCH, CRANE ASSEMBLY-CONTINUED

P-F	3110-554-53	BEARING, BALL:WINCH HOUSING 1208 (21760)	HA, FJ, JA	EA	2	*	*	*	*	*	*	6	10	222	10
P-O	4730-172-00	FITTING, LUBRICATION:WINCH HOUSING MS15003-6 (96906)	HA, FJ, JA	EA	1	*	*	*	*	*	*	6	10	222	11
P-O	4730-050-42	FITTING, LUBRICATION: WINCH HOUSING MS15003-1 (96906)	HA, FJ, JA	EA	1	*	*	*	*	*	*	6	10	222	12
P-F	5305-716-81	SCREW, CAP, HEXAGON HEAD: WINCH HOUSING MS90726-116 (96906)	HA, FJ, JA	EA	4	*	*	*	*	*	*	6	10	222	13
P-F	2520-692-61	HOUSING, WINCH DRIVE: 8331938 (19207)	HA, FJ, JA	EA	1	*	*	*	*	*	*	2	5	222	14
P-F	2520-740-99	SHAFT, DRIVE:WINCH SPROCKET PILLOW BLOCK 7409911 (19207)	HA, FJ, JA	EA	1	*	*	*	*	*	*	2	5	222	15
P-F	5305-269-32	SCREW, CAP, HEXAGON HEAD: WINCH HOUSING CAP MS90725-62 (96906)	HA, FJ, JA	EA	8	*	*	*	*	*	*	6	20	222	16
P-F	5310-637-95	WASHER, LOCK:WINCH HOUSING CAP MS35338-46 (96906)	HA, FJ, JA	EA	8	*	*	*	*	*	*	6	20	222	17
P-F	5310-732-05	NUT, PLAIN:WINCH HOUSING MS51968-14 (96906)	HA, FJ, JA	EA	4	*	*	*	*	*	*	6	10	222	18
X1		NUT, PLAIN:WINCH HOUSING 105685 (24076)	HA, FJ, JA		4									222	19
X1		STUD:WINCH HOUSING 105822 (24076)	HA, FJ, JA		2									222	20
P-F	2520-740-96	AIR CYLINDER ASSEMBLY: 7406974 (19207)	HA, FJ, JA	EA	1	*	*	*	*	*	*	6	10	223	1
X2-O		BEARING: PILLOW BLOCK 6Y1353SA (24706)	HA, FJ, FA	EA	1	*	*	*	*	*	*			224	1
X2-O		SCREW: BEARING 82X3005 (24706)	HA, FJ, JA	EA	1	*	*	*	*	*	*			224	2
P-O	4730-049-81	FITTING, LUBRICATION: 1988 (70270)	HA, FJ, JA	EA	1	*	*	*	*	*	*	6	10	224	3
P-O	4730-430-32	ADAPTER:TUBE FITTING 51942 (70270)	HA, FJ, JA	EA	1	*	*	*	*	*	*	4	8	224	4
X2-O		PIN:ADAPTER PILLOW BLOCK 6Y6802 (24076)	HA, FJ, JA	EA	1	*	*	*	*	*	*			224	5

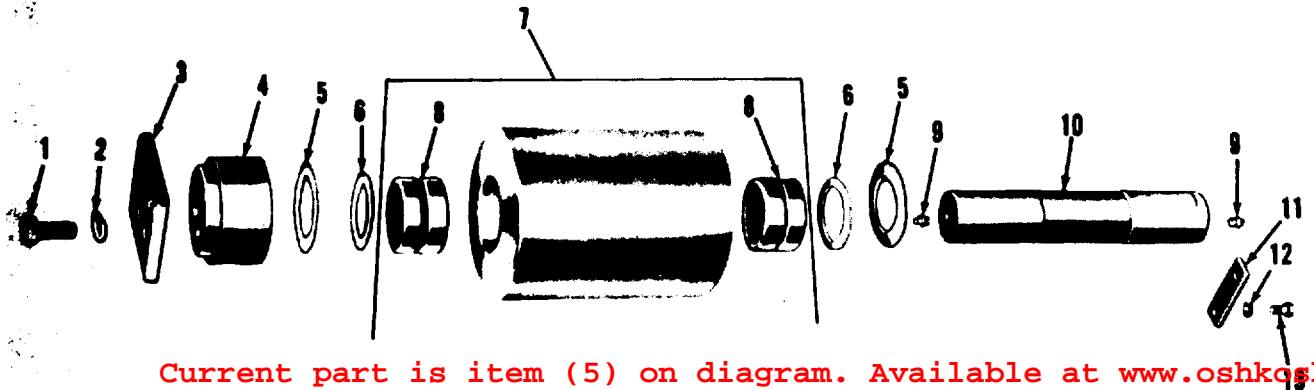

Current part is item (5) on diagram. Available at [www.oshkoshequip.com](http://www.oshkoshequip.com)

AT 47316

Figure 221. Rear winch side roller.

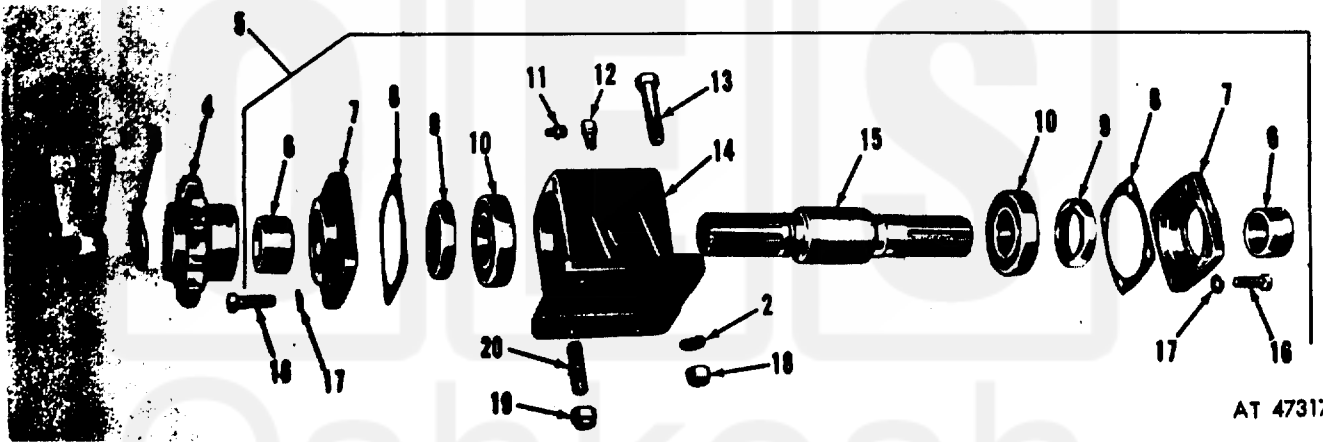

AT 47317

Figure 222. Winch drive shaft housing.

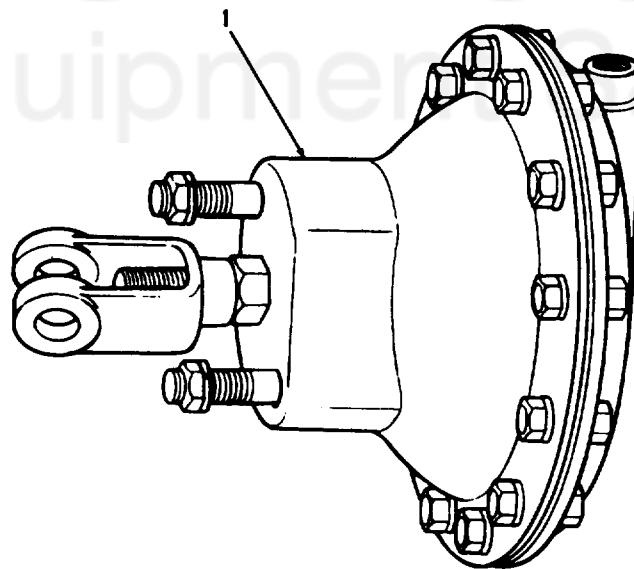

AT 47318

Figure 223. Winch air cylinder.

Current part is item (5) on diagram. Available at [www.oshkoshequip.com](http://www.oshkoshequip.com)